



# Elizabethtown College

## Information & Technology Services

To connect the document camera via USB to the computer, plug the cable shown (1) into the USB input (2), located on the side of the document camera.

Set the video interface to USB by clicking on the monitor icon in the top right of the document camera screen (3) and select USB (4).

Once a Zoom Session is open, navigate to settings (5). Once the settings open, click the Video Settings (6) and change the Camera to USB\_Camera (7).

Go to <https://bit.ly/3oeSLdO> for more info on screen sharing in Zoom



To connect the document camera via Zoom, it **must** be connected via **USB**.

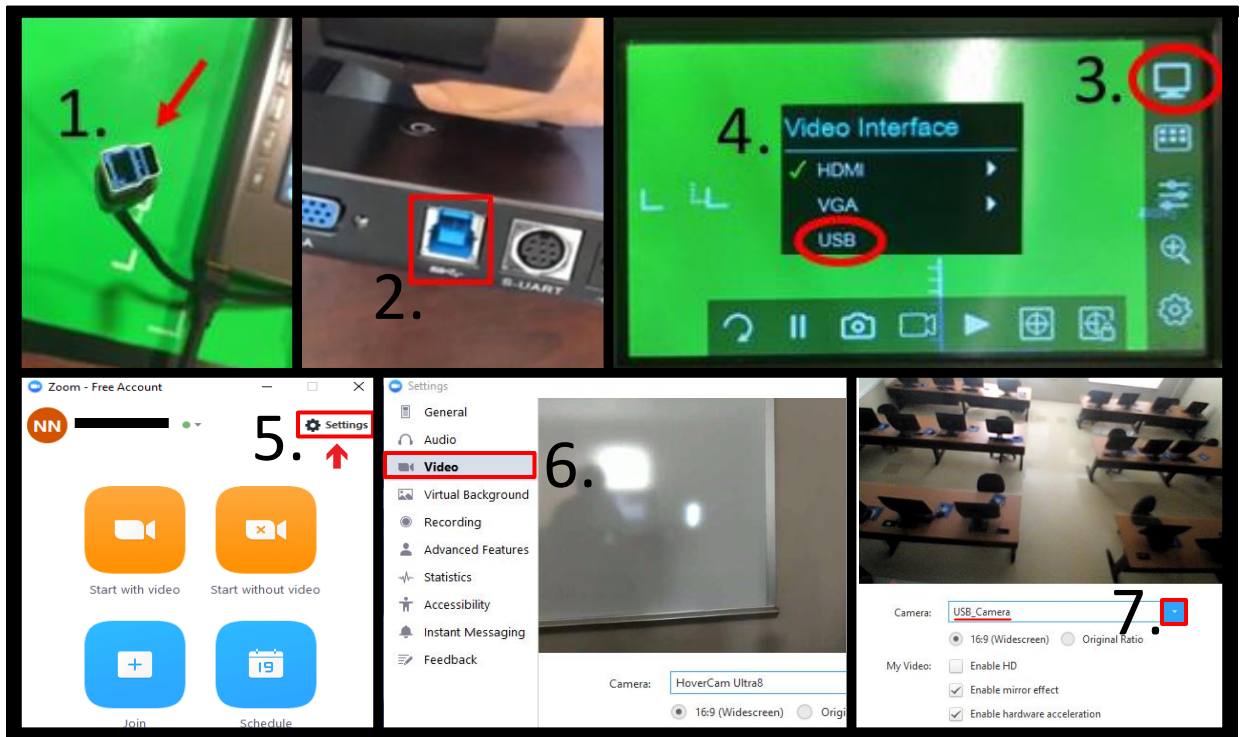

**Need Help? Call 717-361-3333**



# Elizabethtown College

## Information & Technology Services



Things to keep in mind while using the document camera via USB

Note: While USB is the selected source, the Creston Panel (1) cannot select the document camera and its controls.

If you change the document camera to show through HDMI (can control from Creston Control Panel), make sure to select the source back to USB (2) to use on the computer.

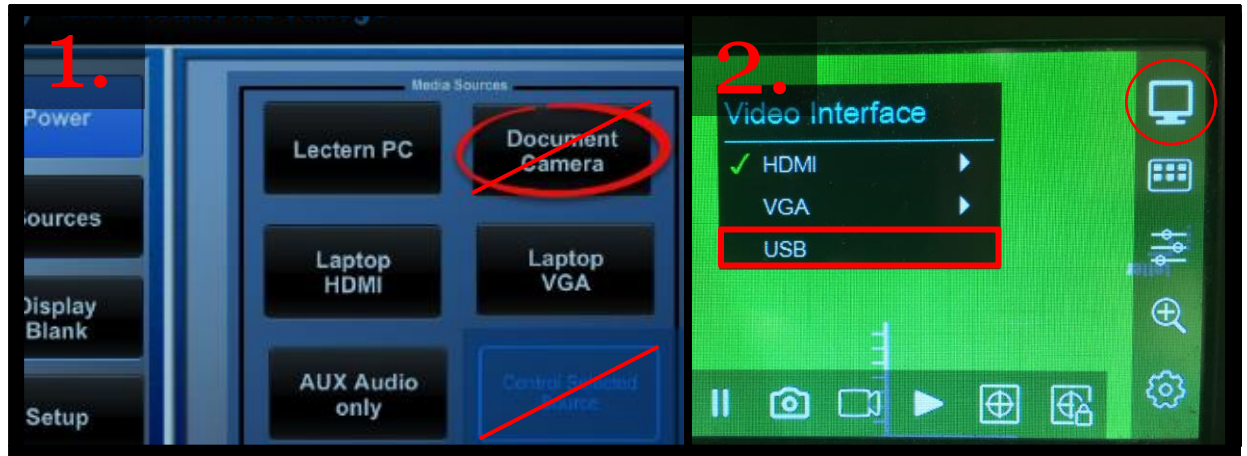

**Need Help? Call 717-361-3333**